



Phoenix Road, London, NW1

BUTLER & STAG



Located in the heart of London is this two double bedroom apartment within striking distance of Euston and Kings Cross St Pancras stations.



- Two Double Bedrooms
- Well Presented Throughout
- Located Between Euston and Kings Cross
- Available 10th June
- Furnished
- Modern Kitchen
- Smart Shower Room
- Close to Regents Park

Offered in good decorative order throughout and facing out to a well-maintained internal courtyard, this second floor apartment comprises of two double bedrooms, a spacious reception room, separate modern kitchen with breakfast bar, shower room and additional WC.

This exceptionally well-located property comes furnished and is available from 10th June 2023.





Chamberlain House, NW1

Approx. Gross Internal Area 738 Sq Ft - 68.56 Sq M

BUTLER & STAG

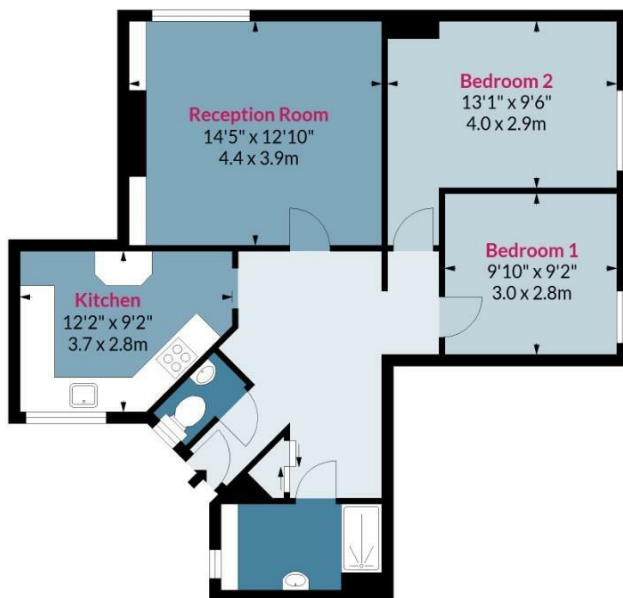

Second Floor

Floor Area 738 Sq Ft - 68.56 Sq M



Measured according to RICS IPMS2. Floor plan is for illustrative purposes only and is not to scale. Every attempt has been made to ensure the accuracy of the floor plan shown, however all measurements, fixtures, fittings and data shown are an approximate interpretation for illustrative purposes only. 1 sq m = 10.76 sq feet.

lpaplus.com

Date: 24/4/2023

IMPORTANT NOTICE - These particulars have been prepared in good faith and they are not intended to constitute part of an offer or contract. We have not performed a structural survey on this property and the services, appliances and specific fittings have not been tested. All photographs, measurements, floor plans and distances referred to are given as a guide and should not be relied upon.

BUTLER & STAG

☎ 020 8102 1236

🏠 508 Roman Road, Bow, London, E3 5LU

✉ bow@butlerandstag.com

www.butlerandstag.uk